

HAWTHORNE RARE SECOND GENERATION PRIME RETAIL SPACE



FOR LEASE

Walk Score
96

Bike Score
100

Transit Score
49

ADDRESS

3418-3426 SE Hawthorne Blvd
Portland, OR 97214

AVAILABLE SPACE

4,816 SF - can be demised to 1,120 SF

RENTAL RATE

\$28.00-\$32.00 PSF/YR plus NNN

TRAFFIC COUNT

SE Hawthorne Blvd - 19,104 ADT ('22)

HIGHLIGHTS

- Prime retail space in the heart of the Hawthorne shopping district. Unbeatable location for retail tenants seeking maximum visibility, excellent co-tenancy and prime exposure. Second generation build out with light-filled showroom/retail sales floor, three restrooms, three storefront entry doors, and back storage/office space. Flexible layout for a variety of concepts.
- Nearby retailers and restaurants include Farmhouse Kitchen Thai Cuisine, Dosh, Hello India, Harlow, Moberi, The Waffle Window, Bread & Ink Café, McMenamins Bagdad Theater & Pub, The Perfume House and more.
- Available now!



COMMERCIAL
REALTY ADVISORS
NORTHWEST LLC

Kathleen Healy 503.880.3033 | kathleen@cra-nw.com
Ashley Heichelbech 503.490.7212 | ashley@cra-nw.com

503.274.0211
www.cra-nw.com

HAWTHORNE PRIME RETAIL
3418-3426 SE HAWTHORNE BLVD
PORTLAND, OR

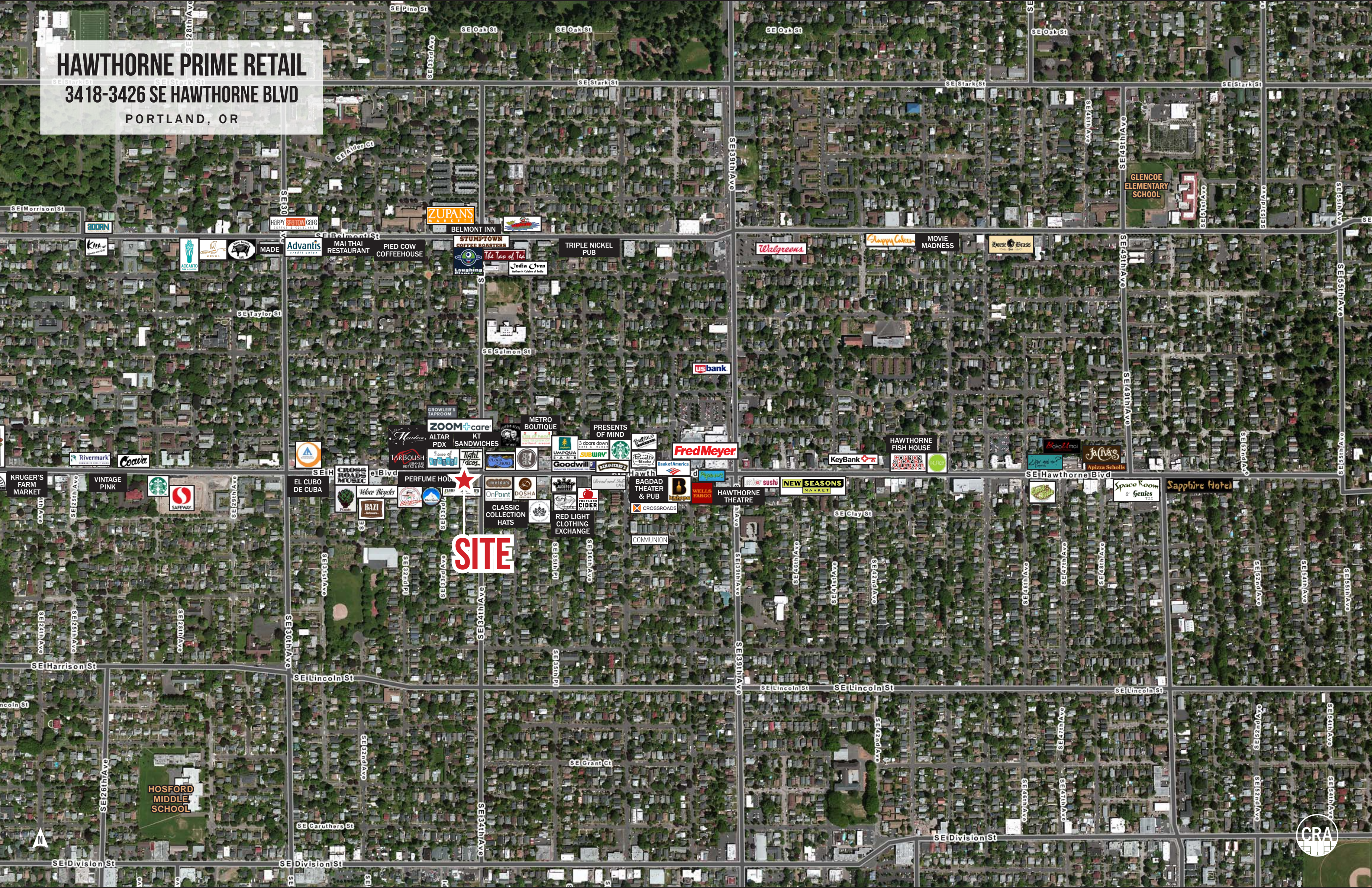

SITE

GLENCOE
ELEMENTARY
SCHOOL

HOSFORD
MIDDLE
SCHOOL



HAWTHORNE PRIME RETAIL
3418-3426 SE HAWTHORNE BLVD
PORTLAND, OR

SITE PLAN



SE HAWTHORNE BLVD

SE 34TH AVENUE

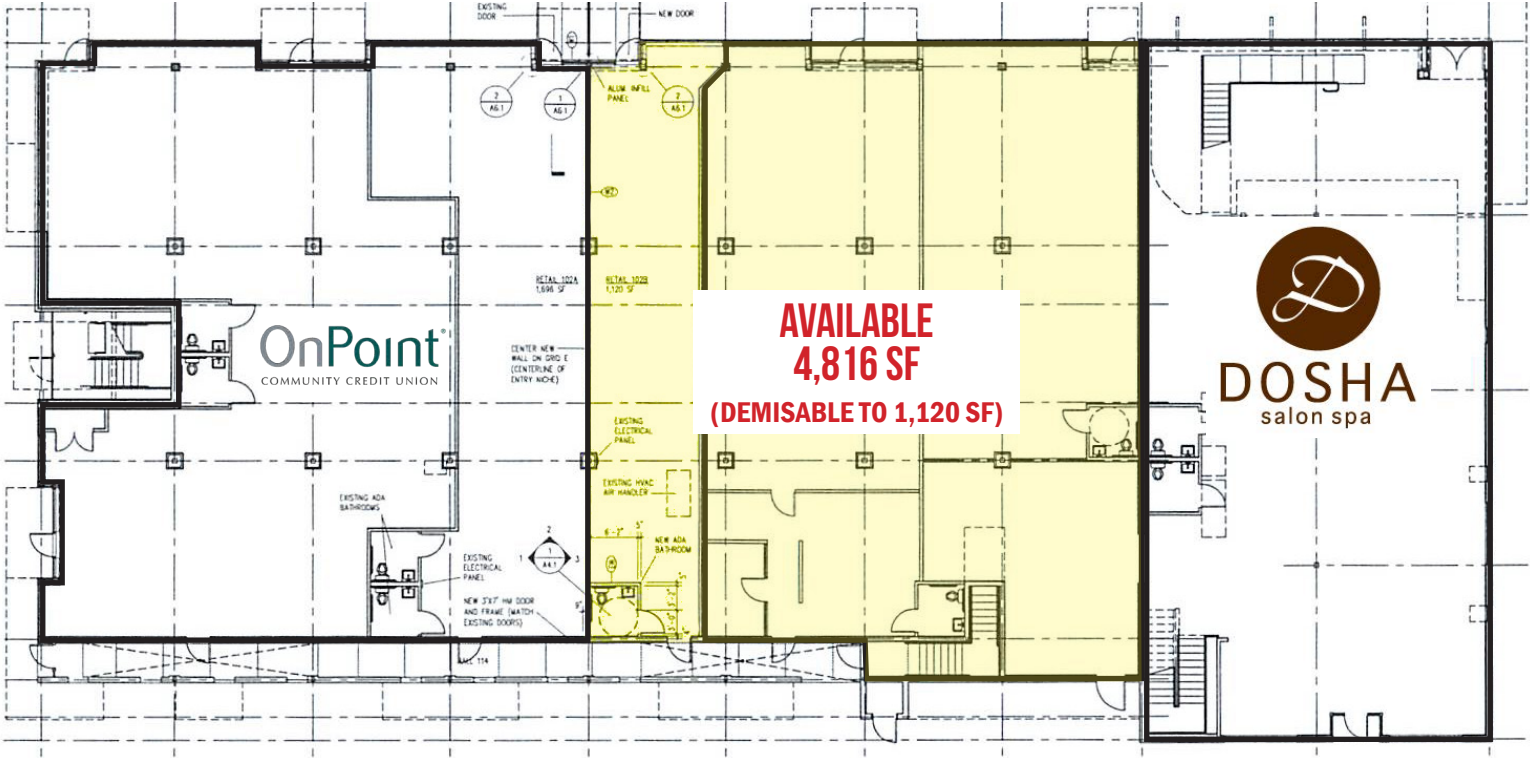

AVAILABLE
4,816 SF
(DEMISABLE TO 1,120 SF)



HAWTHORNE PRIME RETAIL

3418-3426 SE HAWTHORNE BLVD

PORTLAND, OR

DEMOGRAPHIC SUMMARY

Source: Regis - SitesUSA (2022)	1 MILE	3 MILE	5 MILE
Estimated Population 2022	36,603	229,721	502,723
Projected Population 2027	37,361	234,230	508,980
Average HH Income	\$109,680	\$106,101	\$106,527
Median Home Value	\$570,452	\$535,448	\$500,708
Daytime Demographics 16+	19,296	291,146	507,025
Some College or Higher	88.4%	83.8%	79.2%

36.0

Median Age

1 MILE RADIUS

\$570,452

Median Home Value

1 MILE RADIUS

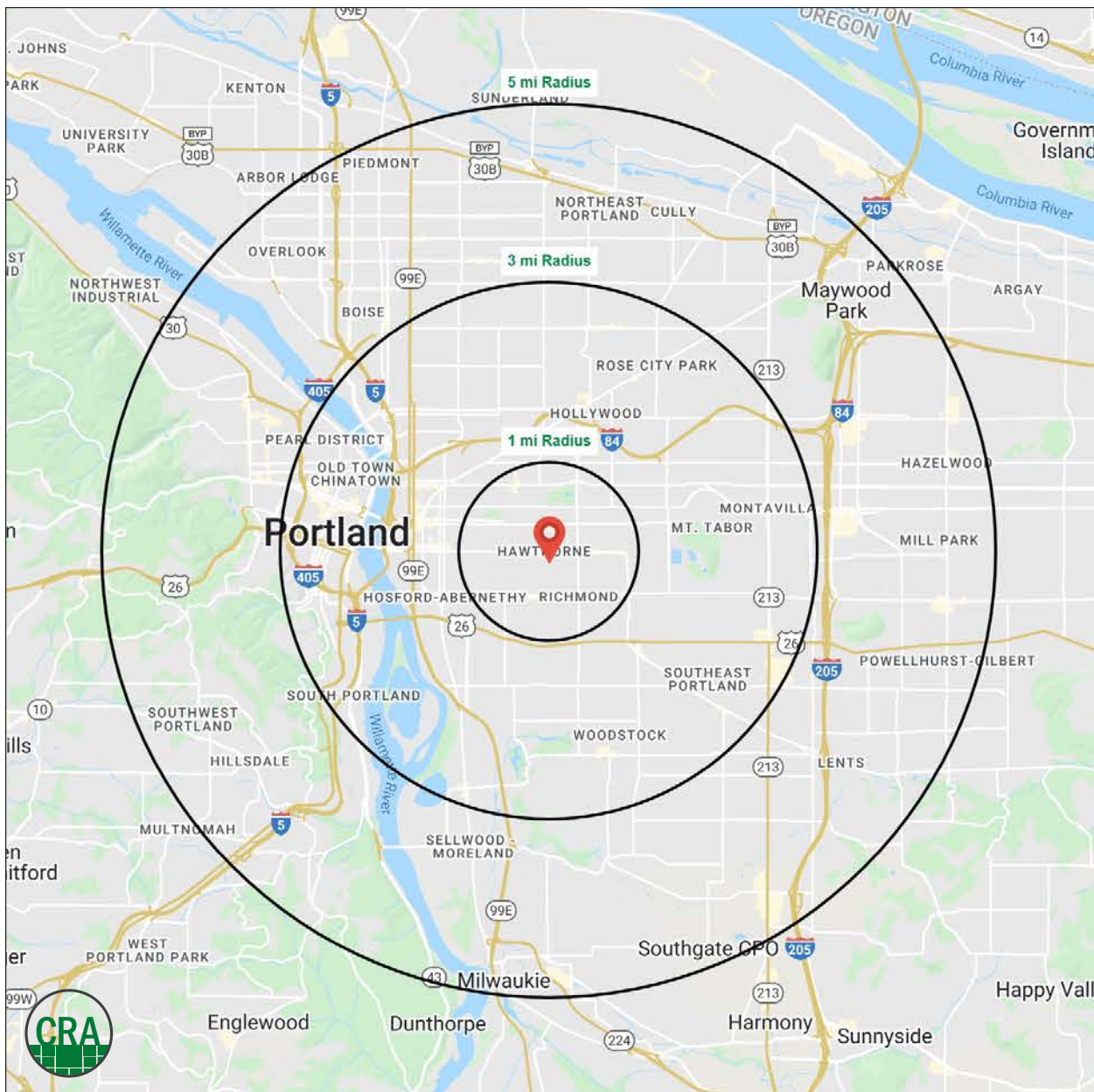

Summary Profile

2010-2020 Census, 2022 Estimates with 2027 Projections
 Calculated using Weighted Block Centroid from Block Groups



Lat/Lon: 45.5119/-122.6292

3418 SE Hawthorne Blvd Portland, OR 97214	1 mi radius	3 mi radius	5 mi radius
Population			
2022 Estimated Population	36,603	229,721	502,723
2027 Projected Population	37,361	234,230	508,980
2020 Census Population	36,920	232,276	508,266
2010 Census Population	32,039	202,346	450,123
Projected Annual Growth 2022 to 2027	0.4%	0.4%	0.2%
Historical Annual Growth 2010 to 2022	1.2%	1.1%	1.0%
2022 Median Age	36.0	37.9	37.4
Households			
2022 Estimated Households	17,291	110,936	225,987
2027 Projected Households	17,716	113,657	230,438
2020 Census Households	17,440	111,997	228,330
2010 Census Households	15,173	95,066	198,806
Projected Annual Growth 2022 to 2027	0.5%	0.5%	0.4%
Historical Annual Growth 2010 to 2022	1.2%	1.4%	1.1%
Race and Ethnicity			
2022 Estimated White	80.0%	74.2%	70.2%
2022 Estimated Black or African American	1.5%	3.4%	5.1%
2022 Estimated Asian or Pacific Islander	4.9%	7.7%	8.4%
2022 Estimated American Indian or Native Alaskan	0.5%	0.8%	1.0%
2022 Estimated Other Races	13.0%	13.8%	15.2%
2022 Estimated Hispanic	8.4%	9.9%	11.6%
Income			
2022 Estimated Average Household Income	\$109,680	\$106,101	\$106,527
2022 Estimated Median Household Income	\$92,811	\$83,417	\$82,785
2022 Estimated Per Capita Income	\$52,028	\$51,694	\$48,263
Education (Age 25+)			
2022 Estimated Elementary (Grade Level 0 to 8)	0.9%	1.8%	2.7%
2022 Estimated Some High School (Grade Level 9 to 11)	1.5%	2.8%	3.4%
2022 Estimated High School Graduate	9.2%	11.6%	14.7%
2022 Estimated Some College	18.3%	18.6%	19.0%
2022 Estimated Associates Degree Only	5.7%	5.8%	6.6%
2022 Estimated Bachelors Degree Only	39.2%	34.4%	31.6%
2022 Estimated Graduate Degree	25.3%	25.1%	22.0%
Business			
2022 Estimated Total Businesses	2,328	23,194	39,766
2022 Estimated Total Employees	11,374	226,788	371,244
2022 Estimated Employee Population per Business	4.9	9.8	9.3
2022 Estimated Residential Population per Business	15.7	9.9	12.6

For more information, please contact:

ASHLEY HEICHELBECH 503.490.7212 | ashley@cra-nw.com

KATHLEEN HEALY 503.880.3033 | kathleen@cra-nw.com



KNOWLEDGE

RELATIONSHIPS

EXPERIENCE



**COMMERCIAL
REALTY ADVISORS
NORTHWEST LLC**

Licensed brokers in Oregon & Washington

 15350 SW Sequoia Parkway, Suite 198 • Portland, Oregon 97224



www.cra-nw.com



503.274.0211

The information herein has been obtained from sources we deem reliable. We do not, however, guarantee its accuracy. All information should be verified prior to purchase/leasing. View the Real Estate Agency Pamphlet by visiting our website, www.cra-nw.com/home/agency-disclosure.html. CRA PRINTS WITH 30% POST-CONSUMER, RECYCLED-CONTENT MATERIAL.